

**Model:** Power-Xtra PX10370P - 3.2V 130 mAh Li-ion Cell-25C

**Stock Code:** 900.600.503.334

## TECHNICAL INFORMATIONS

Item	Specifications	Conditions
Nominal Voltage	3.2±0.05V	0.2C Discharge
Charging	Method	CC-CV
	Voltage	3.65±0.05V
Typ. Capacity	130 mAh	0.2C discharge
Standard Charge Current	65 mAh (0.5C)	Constant current at 65mA charge to 3.65V, then constant voltage at 3.65V charge till current decline to ≤1.3mA
Standard Discharging Current	26 mAh (0.2C)	Constant current 0.2C / end voltage 2.0 V
Max. Discharge Current	2.000 mAh (15C)	-10°C ~ +60°C
Max. Discharge Current	3.000 mAh (25C)	Cut-off Voltage @2.75V
Temperature	Charge	0 to +45°C
	Discharge	-20 to +60°C
	Storage	Less than 1 year: -20~25°C less than 3 months: -20~40°C
Weight	7 gr	approximately
Cycles Test	<p>The cell shall be charged at a constant current of 2000mA to 3.65V and then charged at a constant voltage of 3.65V till current decline to 13mA(0.1C). After charging, the cell shall be stored for 30mins, then discharged at a constant current of 3000mA to a final voltage of 2.0V. After that, stored for 30mins prior to next charge/discharge cycle.</p> <p>The cell shall be continuously charged and discharged for <b>1000 times</b></p>	

## Technical Drawings

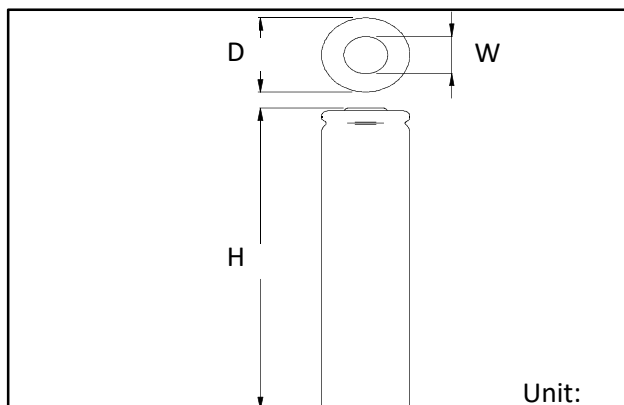

Diameter, D	10.5mm	+0.2
		-0.2
Height, H	37mm	+0.5
		-0.5
Cap Diameter, W	-	+0.3
		-0.3

REV001

Revised Date:09.10.2020