

**Model:** Power-Xtra PX18500H - 3.7V 1200 Mah Li-ion Battery - 5C - with Pins

**Stock Code:** 900.600.503.327

## TECHNICAL INFORMATION

Item	Specifications	Conditions
Nominal Voltage	3.7±0.05V	0.2C Discharge
Charging	Method	CC-CV
	Voltage	4.20±0.05V
Typ. Capacity	1.200 mAh	0.2C discharge
Standard Charge Current	600 mAh (0.5C)	Constant current 0.2C / end voltage 4.2V
Standard Discharging Current	600 mAh (0.5C)	Constant current 0.2C / end voltage 2.75V
Max. Discharge Current	600 mAh (0.5C)	-10°C ~ +60°C
Max. Discharge Current	6.000 mAh (5.0C)	Cut-off Voltage @2.75V
Temperature	Charge	0 to +45°C
	Discharge	-20 to +60°C
	Storage	Less than 1 year: -20~25°C
		less than 3 months: -20~40°C
Weight	31 gr	approximately
Cycles Test	Higher than 70% of the Initial Capacities of the Cells Carry out 300cycle Charging/Discharging in the below condition. ♦Charge: Standard Charge ♦Discharge:0.5C to 2.75 V ♦Rest Time between charge /discharge:30min. ♦Temperature:20±5°C	

## Technical Drawings

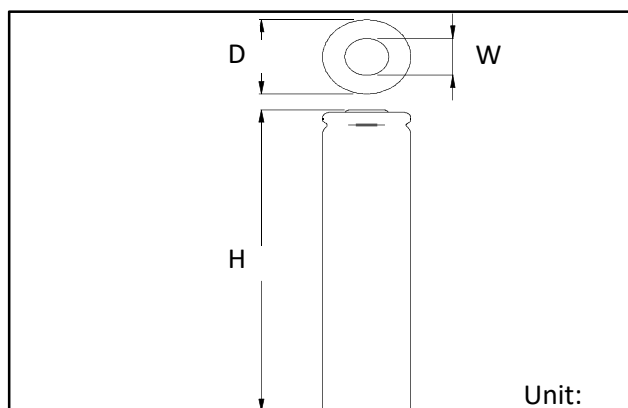

Diameter, D	18.3mm	+0.2
		-0.2
Height, H	50mm	+0.5
		-0.5
Cap Diameter, W	8mm	+0.3
		-0.3

**REV002**

Revised Date:03.09.2020

**Model:** Power-Xtra PX18500H - 3.7V 1200 Mah Li-ion Battery - 5C - with Pins

**Stock Code:** 900.600.503.327

## PIN Type -Drawing

